

WELCOME BACK!

Welcome to Central Campus! We are excited to learn with you. The following information will help you navigate our Hybrid/Virtual life at Central Campus.

Remember, if you have any questions, just ask. We are here to help you have a great learning experience.



Think.Learn.Grow

KEY PEOPLE AT CENTRAL CAMPUS

Tascha Brown

Director, Central Campus

Tascha.brown@dmschools.org

Lisa Hill

Associate Principal, Central Campus

Lisa.hill@dmschools.org

Sonya Smith

Community Schools Coordinator

Sonya.smith@dmschools.org

Beth Angier

Nurse

Elizabeth.angier@dmschools.org

John Hickling, Jenn Scott & Mary Vang

Counseling & Scheduling

John.hickling@dmschools.org (A-L)

Jennifer.scott@dmschools.org (M-Z)

Mary.vang@dmschools.org

Shelia Sprague & Patty Couch

Executive Assistant & Attendance

Shelia.sprague@dmschools.org

Patricia.couch@dmschools.org

- **Attendance: 242-7653**
- **Main office: 242-7846**

DIFFERENT SUPPORTS

- **Canvas support-** please reach out to your child's teacher or home school contact.
- **We are happy to meet with you, but due to Covid protocol, you must schedule a meeting before coming into the school.**
- **[Online Family Resource](#) link with many supports**

WEEKLY HYBRID & VIRTUAL SCHEDULES

There are different schedules for Central Campus:

- **Hybrid**
 - M, T, TH
 - F
- **Virtual**
 - Meets M-F online

*Schedules are subject to change due to inclement weather or Covid-19.

**Students must exit the building on time. There is no waiting in the cafeteria/commons area.

**Central Campus
Class/Bus Schedule**
Fall 2020
Monday, Tuesday & Thursday

Arrival to CC	8:20am (All students arrive/delivered to <u>Central Campus</u>)
AM BLOCK	8:40– 11:30am (class time)
<i>Ag Bus to Ag</i>	8:40am (<i>Ag Science</i> students board bus & delivered to <u>Ag building</u> by 9:00)
PM Arrival to CC	11:50am (Aternoon students arrive/delivered to <u>Central Campus</u>)
LUNCH	11:35am -12:15pm
PM BLOCK	12:20 – 3:05pm (class time)
AM Departs CC	11:55am (buses take morning students home)
<i>Ag Bus to CC</i>	2:50pm (<i>Ag Science</i> students brought back to <u>Central Campus</u> by 3:05)
Depart from CC	3:10pm (buses take students home)

**Central Campus
Class/Bus Schedule**
Fall 2020
Friday

Arrival to CC	8:20am (All students delivered to <u>Central Campus</u>)
AM BLOCK	8:40 – 11:30am (class time)
<i>Ag Bus to Ag</i>	8:45am (<i>Ag Science</i> students board bus & delivered to <u>Ag building</u> by 9:00)
<i>Ag Bus to CC</i> (Friday only)	11:20 am (Friday <i>Ag Science</i> students board bus & brought back to <u>Central Campus</u> by 11:35)
PM Arrival to CC	11:50am (Aternoon students delivered to <u>Central Campus</u>)
LUNCH	11:35am -12:15pm
PM BLOCK	12:20 – 3:05pm (class time)
AM Departs CC	11:55am (buses take morning students home)
<i>Ag Bus to Ag</i>	12:15pm (Friday <i>Ag Science</i> students & delivers to <u>Ag building</u> by 12:30)
<i>Ag Bus to CC</i>	2:50pm (<i>Ag Science</i> students brought back to <u>Central Campus</u> by 3:05)
Depart from CC	3:10pm (buses depart to take students home)

INFINITE CAMPUS

GET YOUR SCHEDULE:

Log into Infinite Campus website & use the drop down to choose Academy or Campus!

19-20 North High ▼

19-20 Academy

19-20 North High

Or use the Infinite Campus APP for students.



INFINITE CAMPUS CAN'T LOG IN?

If your password was reset, you'll need to use a DMPS computer on DMPS network the first time you log in.

Parent log in should be the same as last year.

Still having trouble?

See the office manager:

- At your home school
- At Central Campus: Shelia Sprague
(you can find Shelia in the main office.)



BUS ZONES

Remember – the bus only comes at the beginning of the day and at the end of the day- Except FRIDAYS



PARKING

Parking Passes: Will not be issued 1st semester.

- A: Visitors & Student lot
- B & C: Handicap Parking
- D-F: Staff parking
- G: Student Lot

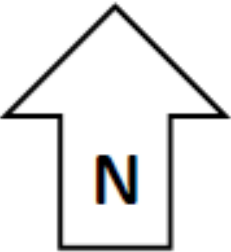
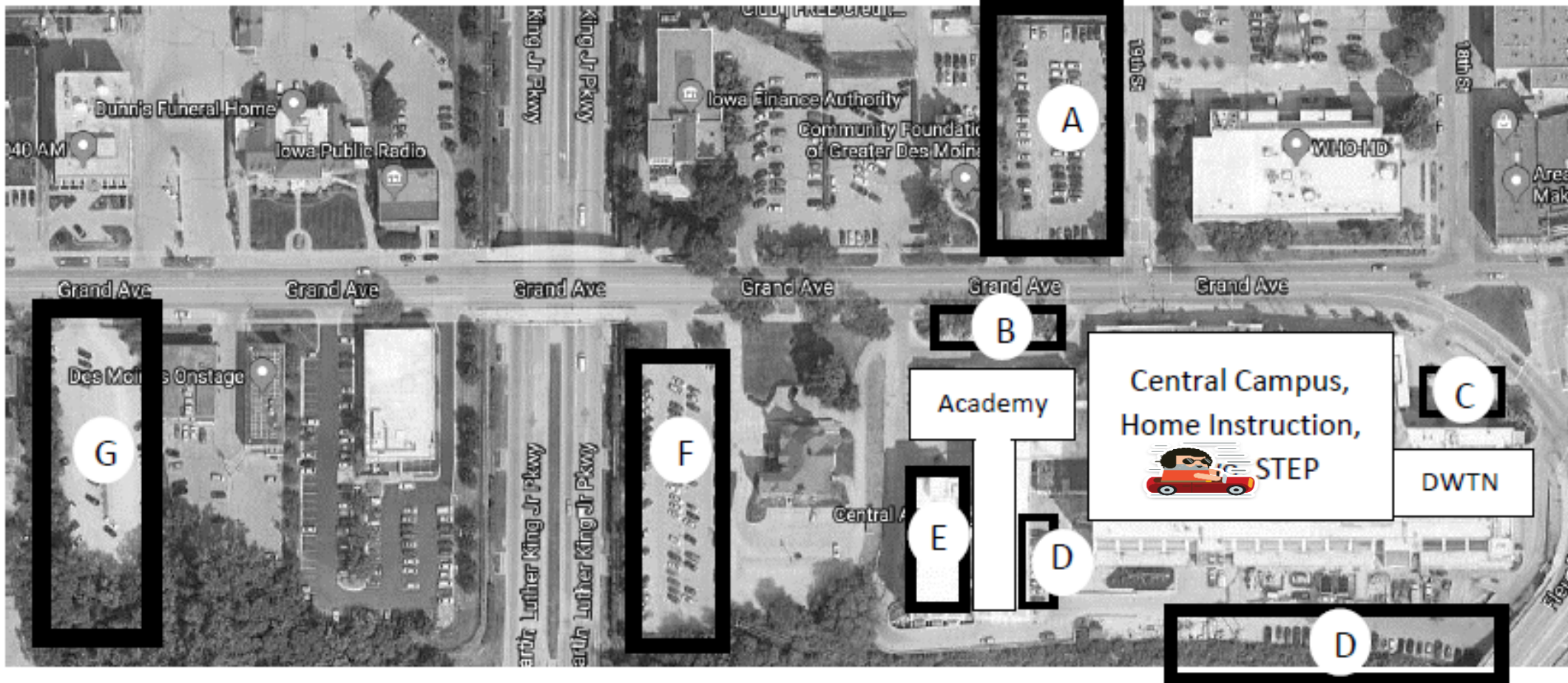

LUNCH INFORMATION



- Lunch begins at 11:35 for AM & All DAY students. AM & ALL DAY students will eat in their classroom.
- PM students eat at 11:50. PM students will eat in the cafeteria.
- If you attend a community eligible school, your eligibility transfers with you to Central.
- You **MUST** have your SCHOOL ID to get a lunch.
- Seating for lunch is restricted to ensure Covid-19 safety protocol is followed.
- Lunch ends at 12:15pm. Students will return to their class or leave the building for the day.

Are you eating lunch at Central Campus today?

If yes, please click on the QR code below
and place your lunch order by

9:30am

for the day.



Thank you!

HOW TO ORDER

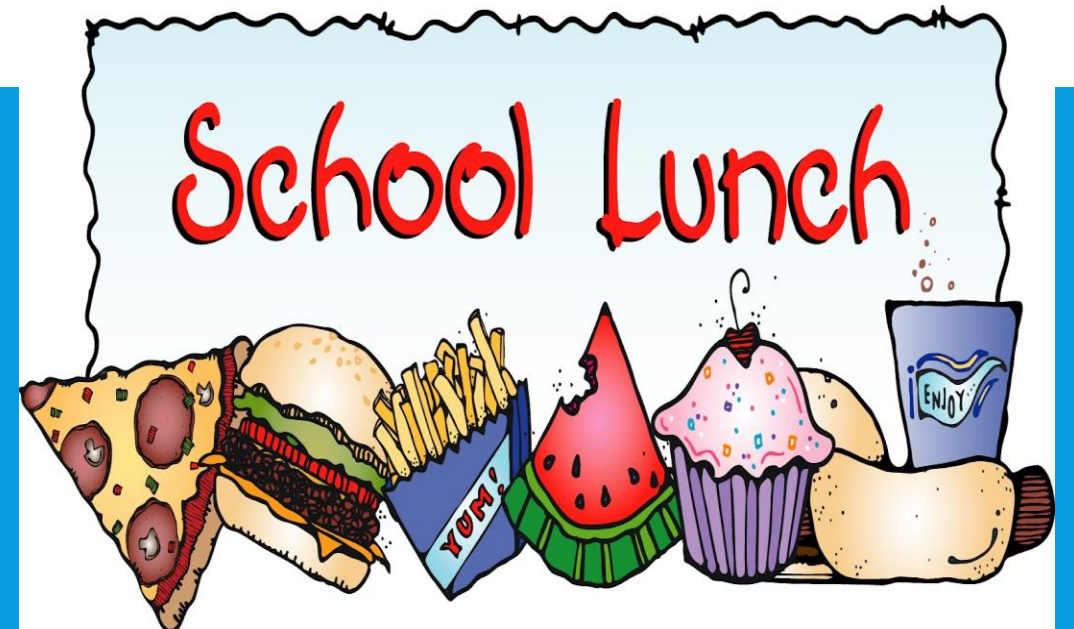

Map of Central Campus Cafeteria

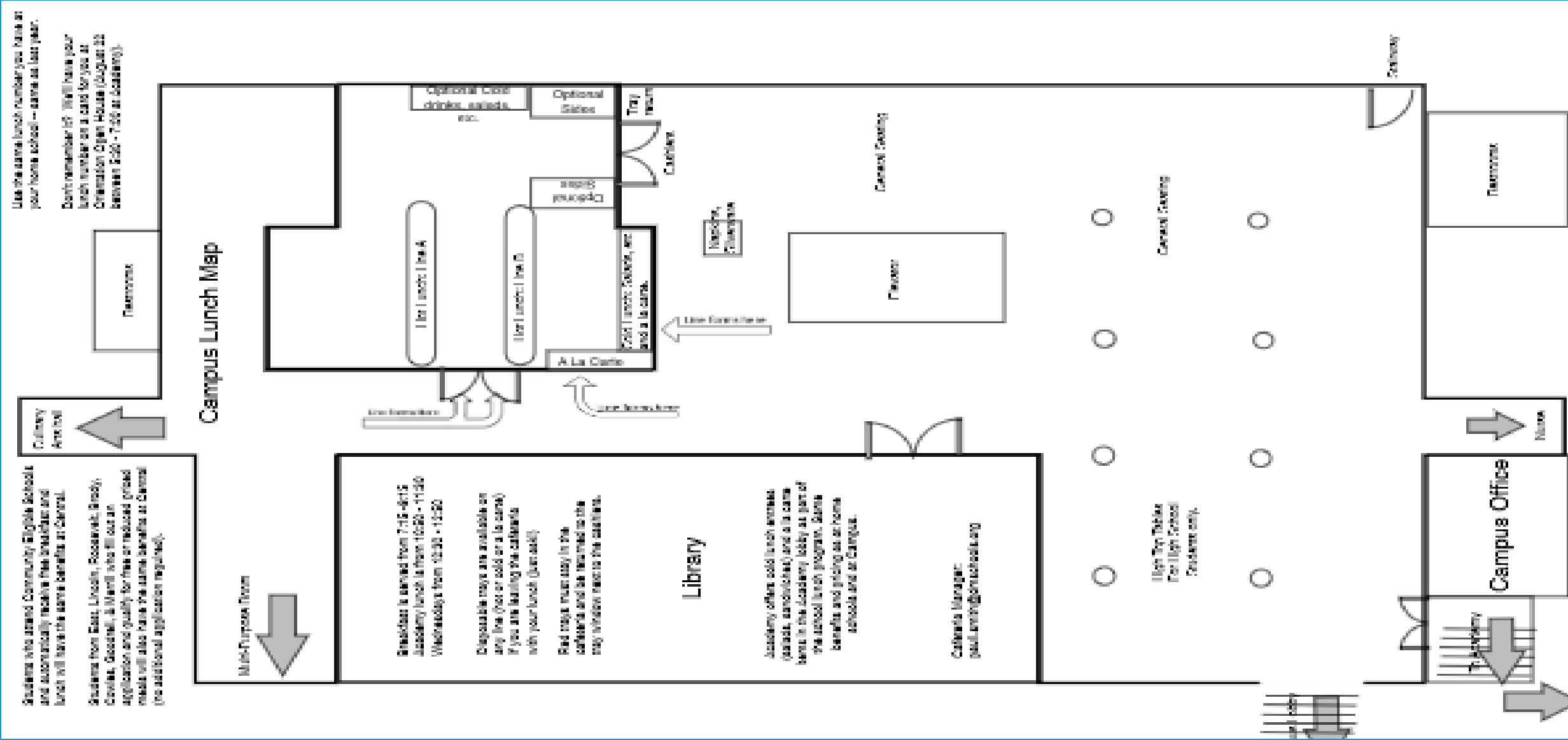

STUDENT ID CARD



It is **very important** to have your **SCHOOL ID** while at school.
Please be prepared to show your School ID upon request.

- Issued at home school for DMPS students.
- Out of District students:
 - See Tamera or Scott in the Central Campus Lobby– to get more info on when & where IDs are being created
- Used for:
 - Ensuring safety of building, getting your school lunch, and more.

DOTS

Central Campus students will receive a **colored dot** to place on their ID to indicate which day they are to be at school.

Students who only attend half the day will also add a **purple** dot to their ID.



FYI

- Bring a Backpack:
- There are no student lockers at Central Campus.



GOT AN APPOINTMENT?

It is helpful to call
Attendance:

Patty Couch

242-7653

Absences are coded as
KNOWN or UNKNOWN



ATTENDANCE:



- Students **sign out** if they are leaving early (with parent permission).
- Students **sign in** when they arrive late (parent call is needed to verify).
- Students will sign in or out at the **front lobby desk** which is located by the Central Campus front doors.
- Students late because of DMPS bus are excused! (no parent action needed).

GOING OUT OF TOWN?

- If you let us know in advance, we can work with you so you don't fall too far behind while you're gone.
- We don't penalize student grades for absences. Talk with us so that we can minimize the effect of missing class.



CENTRAL CAMPUS SUPPORTS

CENTRAL CAMPUS PROVIDES NUMEROUS SUPPORTS TO HELP YOU FIND SUCCESS WITH LIFE.

Contact John Hickling, Jennifer Scott, Sonya Smith, or Mary Vang in the School Counseling Office if you need assistance with the following.

- Scheduling
- Short-term Counseling
- Academic Planning
- Career Planning
- Basic Needs
- Food Pantry
- Community Resources

Would you like to make an appointment?

<https://tinyurl.com/y5xv96ja>

CENTRAL CAMPUS INFORMATION SITES

Stay connected! Besides these sites, please check your Infinite Campus email regularly.



@CentralCampusDM



Create an account. You will be sent a code.
Please contact Sonya Smith if you need
assistance in setting up your account.



centralcampus.dmschools.org

VISITOR SIGN IN



- **Visiting Central Campus will be limited during the Covid-19 Pandemic.**
- Those needed to visit must **schedule an appointment** through Central Campus' main office .
- Once on school grounds, please present your ID to gain access at the front reception desk.
- If you parked in visitor parking we'll ask you to sign in your car with make, model & plate number.

SAFETY IN OUR COVID WORLD

- Students **must wear a mask**. If they don't have one, one will be provided.
- Students who refuse to wear a mask will be sent home.
- 300 hand sanitizing stations around the building.
- If your child is sick, please keep them home.
- If your child has been exposed to Covid-19, please let us know immediately.

QUESTIONS

Have a GREAT
school year!

#Think.Learn.Grow